

Sandford Parks Lido is a nationally important example of a lido, a very distinctive type of recreational landscape that developed across Europe in the 1920s and 1930s. We want to ensure that the character and value of the site is retained for future generations to enjoy.

As part of our application to the Heritage Lottery Fund, which secured the funding for the restoration of the main pool and its surrounding areas, we stated that we will commission and sign up to a Conservation Management Plan. This will help us identify and protect the important aspects of this wonderful site and raise awareness of its value and the benefits that it provides.

A full version with many plans, photographs and drawings, can be found on the Sandford Parks Lido website at www.sandfordparkslido.org.uk.

Your views can be emailed to swim@sandfordparks-lido.org.uk, or simply written on the back of this leaflet and handed in to the ticket office.

The Conservation Plan has brought together the results of new research into the history of the lido and its place in the development of open-air swimming pools, recreation and designed landscapes. These are:

HISTORIC AND DESIGN VALUE

Sandford Parks Lido is one of the best-preserved and most significant lidos in Britain. It is formally planned, in order to control the movement of people around

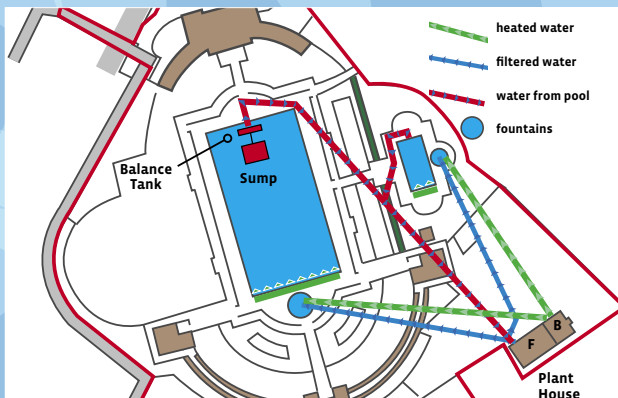

The original system for cleansing and heating the pools has been little altered since the 1930s.

the site, but its architecture and landscaping is heavily influenced – uniquely for a lido – by the English Arts and Crafts movement. Its importance is boosted by the unique survival of the 1930s filters, switch gear and pumps, which were installed to retain the purity of the water.

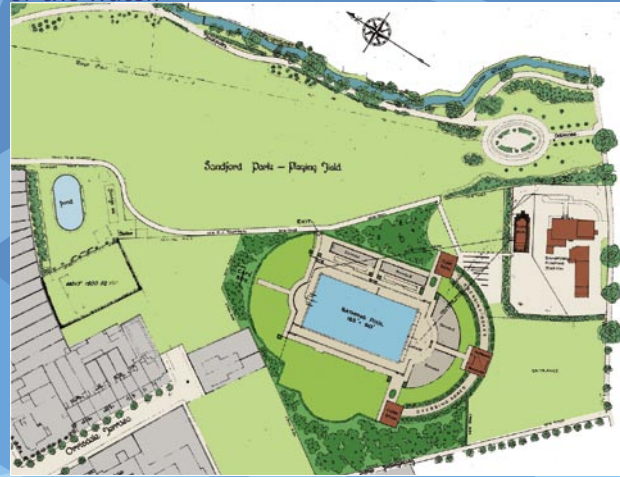

A series of drawings were produced from the Borough Engineer's office in the summer of 1934. This drawing shows how the lido was linked to the recently opened park

EDUCATIONAL VALUE

We will continue to interpret the history and significance of the lido. The lido can serve as a focus for life-long learning and the exchange of experiences between generations. It can also serve as an arena for the arts, and for children to learn about and contribute to our understanding of 'place' through its landscape and buildings.



COMMUNITY AND RECREATIONAL VALUE

The lido is a safe and wonderful environment in which children and adults can play, socialise, keep fit, relax, learn new skills, have fun and gain a sense of physical and emotional well-being.



ECONOMIC VALUE

The lido is one of a series of key venues that contribute to tourism and the prosperity of Cheltenham. It is one of a small number of 50-metre outdoor pools in Britain and has now been accepted as a training venue for the 2012 Olympics.

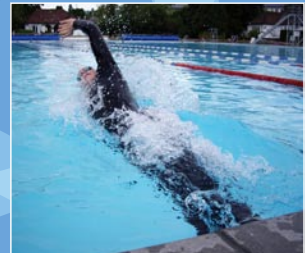

OUR HERITAGE

We would welcome your thoughts on why the lido is a special place for you.

There are a number of factors that you may consider important, ranging from its historic importance, the character and beauty of the whole site, or its value as a place for recreation, sport, the local community, education or the local economy. It does not matter if there is an aspect that does not fit within these headings. We just want to know what you think is important and how you make use of the site.

NOW PLEASE TURN OVER AND LET US HAVE YOUR COMMENTS ON WHY YOU VALUE THE LIDO.